

Down Creek

N 76 1/2 W 19
 N 42 W 64
 -N 11 1/2 W 25
S 60 W 31
 139 per

Up the Creek

S 11 1/2 E 29
 S 42 E 64
 S 76 1/2 E 57
 S 37 1/2 E 20
S 58 E 25
 195 per

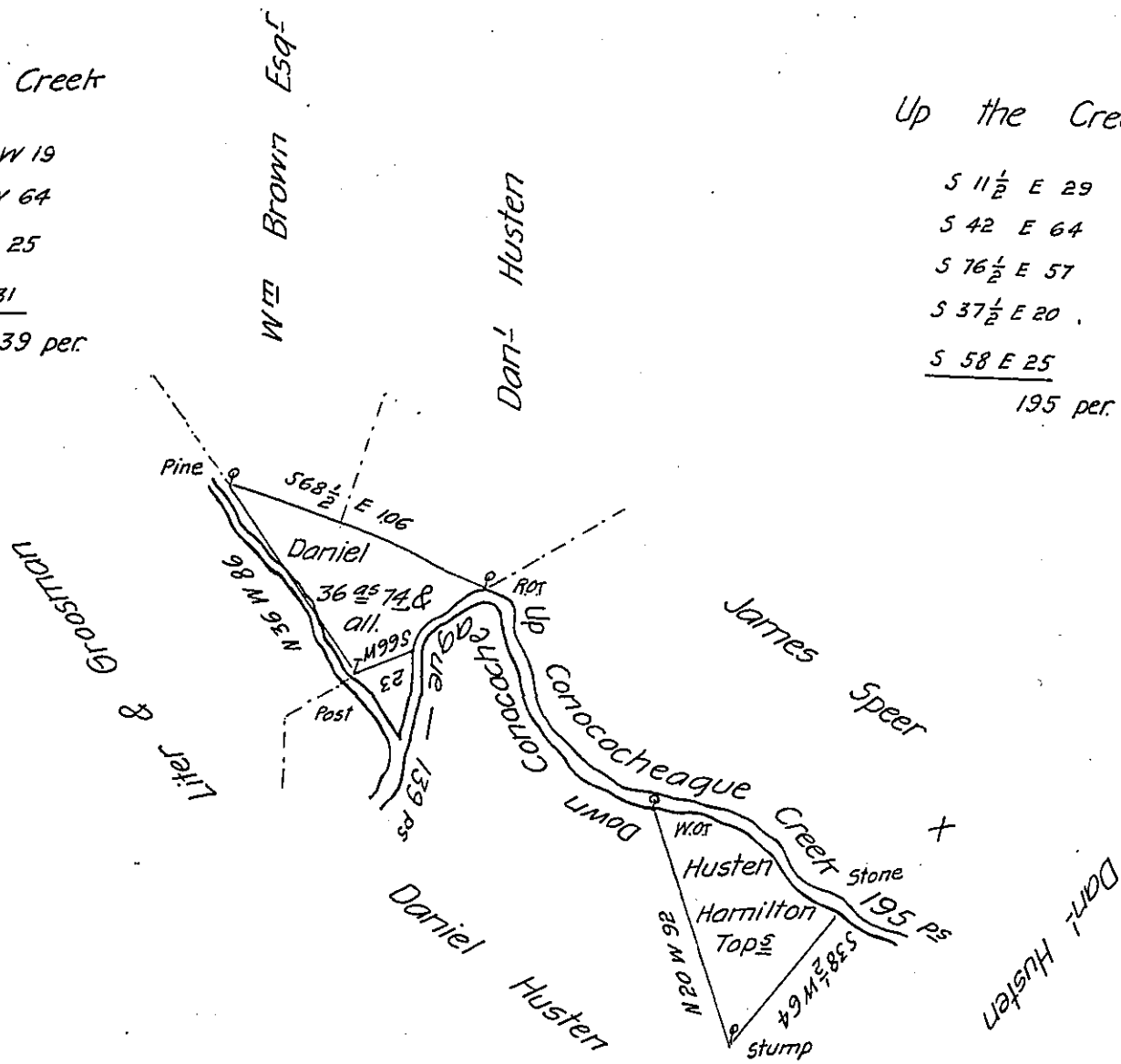

A Draught of a Peice of Land situated part in Guilford & part in Hamilton Townships Franklin County containing thirty six acres & seventy four perches & allowance of six P Cent for roads &c. Surveyed September 12th 1809 in Persuance of a warrant granted to Daniel Husten dated August 29th 1809.

To Andrew Porter Esq^r
 Surveyor General.

Thomas Poe D.S.

IN TESTIMONY that the above is a copy of the original remaining on file in the Department of Internal Affairs of Pennsylvania, made conformably to an Act of Assembly approved the 16th day of February, 1833, I have hereunto set my Hand and caused the Seal of said Department to be affixed at Harrisburg, this fourteenth day of June 1905.

Isaac R. Brown
 Secretary of Internal Affairs.